

# Lely Grazeway

## Selection Box



## Operator Manual

en-US - English Original

5.1530.8532.0 C





INTENTIONALLY BLANK

## Trademarks, Copyright and Disclaimer

Lely, Astronaut, Astri, Atlantis, C4C, Calm, Caltive, Capsule, Commodus, Compedes, Cosmix, Dairywise, Discovery, F4C, Fertiliner, Gravitor, Grazeway, Hubble, I-flow, InHerd, Juno, L4C, Lely Center, Lelywash, Luna, Nautilus, Orbiter, Quaress, Qwes, Shuttle, T4C, Vector, Viseo, Voyager, and Walkway are registered trademarks of the Lely Group.

Lely reserves all rights with respect to its trademarks. Any unauthorized use of any Lely-owned trademark or any use of a trademark that is confusingly similar to, or likely to cause confusion with a Lely-owned trademark, would constitute infringement of Lely's exclusive rights. All rights reserved.

The information given in this publication is provided for information purposes only and does not constitute an offer for sale. Certain products may not be available in individual countries and products supplied may differ from those illustrated.

No part of this publication may be copied or published by means of printing, photocopying, microfilm or any other process whatsoever without prior permission in writing by Lely Holding S.à.r.l. Although the contents of this publication have been compiled with the greatest possible care, Lely cannot accept liability for any damage that might arise from errors or omissions in this publication.

Copyright © 2019 Lely Industries N.V.  
All rights reserved

Lely Industries N.V.  
Cornelis van der Lelylaan 1  
3147 PB Maassluis  
the Netherlands  
Phone: +31 (0)88 1228221  
Fax: +31 (0)88 1228222  
Website: [www.lely.com](http://www.lely.com)



INTENTIONALLY BLANK

5.1530.8532.0 C

## List of Included Amendments

| No: | Issue Date<br>(yyyy/mm) | Chapter(s) | Remarks  |
|-----|-------------------------|------------|--|
| A   | 2018/11                 |            | Initial issue for validation   |
| B   | 2019/01                 |            | Initial issue  |
| C   | 2019/07                 |            | Added: Qwes IR reader (5.1530.0060.1) and Qwes LD reader (5.1530.0070.1) |



INTENTIONALLY BLANK

5.1530.8532.0 C

# Preface

## Manual Contents

This manual contains the information for the correct operation and maintenance of the Grazeway. The information in this manual is for operators to operate the machine.



Study and understand this information thoroughly before you do maintenance on the machine. Failure to do so could result in damage to equipment or personal injury . Please consult your local Lely service provider if you do not understand the information in this manual, or if you need additional information. Store this manual in a safe place for future reference.

All information in this manual has been compiled with care. Lely shall not be liable for errors or faults in this manual. The recommendations are meant to serve as guidelines. All instructions, pictures and specifications in this manual are based on the latest information that was available at the time of publication. Your machine may comprise improvements, features or options that are not covered in this manual.

## Applicability

| Model   | Type number   |
|---|---------------|
| Lely Grazeway Selection Box with ISO (ISO FDX) identification                     | 5.1530.0050.1 |
| Lely Grazeway Selection Box with IR (infrared) identification                     | 5.1530.0060.1 |
| Lely Grazeway Selection Box with LD (infrared and radio frequency) identification | 5.1530.0070.1 |

## Standard Torque Loading of Parts

All the nuts, bolts and screws used on the return box are torque tightened to standard torque loadings applicable to the construction materials used.

If a part has a non-standard torque loading, it is specified in the applicable part of the manual.

## Registration

The type and serial number plate is attached to the top panel of the Grazeway. Always include the type and serial numbers of the selection box when you contact your local Lely service provider or order spare parts.

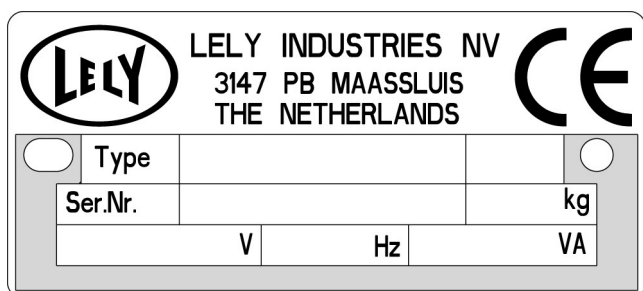

Figure 1. Type and serial number plate

We suggest that you complete the table below with the type and serial numbers of your machine. This makes sure that you can easily find the information.

|               |  |
|---------------|--|
| Type number   |  |
| Serial number |  |



# Table of Contents

|          |   |            |
|----------|---|------------|
| <b>1</b> | <b>The Lely Grazeway Selection Box</b>          | <b>1-1</b> |
| 1.1      | The Grazeway                                    | 1-1        |
| 1.2      | Intended Use                                    | 1-1        |
| <b>2</b> | <b>Safety</b>                                   | <b>2-1</b> |
| 2.1      | Signal Icons                                    | 2-1        |
| 2.2      | Safety Instructions                             | 2-2        |
| 2.2.1    | General Safety                                  | 2-2        |
| 2.2.2    | Electrical Safety                               | 2-2        |
| 2.2.3    | Maintenance Safety                              | 2-2        |
| <b>3</b> | <b>Specifications</b>                           | <b>3-1</b> |
| 3.1      | Specifications and Requirements                 | 3-1        |
| 3.2      | Dimensions and Weight                           | 3-2        |
| <b>4</b> | <b>Description</b>                              | <b>4-1</b> |
| 4.1      | General Description                             | 4-1        |
| 4.2      | Portal, Frames and Gates                        | 4-2        |
| 4.3      | Control Unit                                    | 4-2        |
| 4.3.1    | Control Box with PCB and Identification Control | 4-2        |
| 4.3.2    | Photocells                                      | 4-3        |
| 4.3.3    | Pneumatic Valves                                | 4-3        |
| 4.3.4    | Main Valve Pressurized Air                      | 4-4        |
| 4.4      | Cow Identification System                       | 4-4        |
| 4.4.1    | ISO Identification Reader                       | 4-4        |
| 4.4.2    | IR and LD Identification Reader                 | 4-4        |
| 4.5      | Additional Segregation Gate (Optional)          | 4-4        |
| 4.6      | Software  | 4-4        |
| 4.6.1    | Grazeway Software                               | 4-5        |
| 4.6.2    | T4C management software                         | 4-5        |
| 4.6.3    | ID Reader Software                              | 4-5        |
| 4.7      | Operation                                       | 4-5        |
| <b>5</b> | <b>Operating Instructions</b>                   | <b>5-1</b> |
| 5.1      | General Instruction                             | 5-1        |
| <b>6</b> | <b>Maintenance</b>                              | <b>6-1</b> |
| 6.1      | Clean the Grazeway                              | 6-1        |
| 6.2      | Clean the Photocell                             | 6-2        |
| 6.3      | Preventive Maintenance before the Winter Season | 6-2        |



|           |                                     |             |
|-----------|-------------------------------------|-------------|
| <b>7</b>  | <b>Troubleshooting</b>              | <b>7-1</b>  |
| <b>8</b>  | <b>Disposal</b>                     | <b>8-1</b>  |
| <b>9</b>  | <b>WEEE</b>                         | <b>9-1</b>  |
| <b>10</b> | <b>EC Declaration of Conformity</b> | <b>10-1</b> |

# 1 The Lely Grazeway Selection Box

## 1.1 The Grazeway

The Grazeway Selection Box enables the segregation of cows in multiple directions like the pasture and a separation room. The segregation is based on the group the cow belongs to or the status of the cow (for example near to be milked, milked or segregation on attention).

The Grazeway has standard two exits. One or two additional segregation gates can be installed. Each segregation gate increases the number of exits with 1.

Each cow has an identification tag. The Grazeway has a cow identification system and pneumatically controlled gates.

The criteria for the selection is done with the T4C farm management software.

## 1.2 Intended Use

The Grazeway selection box is used to identify cows in the barn and to segregate them into different directions (like the pasture or a separate room), dependent on the group the cow belongs to or the status of the cow.



INTENTIONALLY BLANK

5.1530.8532.0 C

## 2 Safety

### 2.1 Signal Icons

Note the use of the signal words DANGER, WARNING and CAUTION with the safety messages. The signal word for each message uses the following guidelines:



#### **Danger**

**Indicates a hazardous situation which, if not avoided, will result in death or serious injury.**



#### **Warning**

**Indicates a hazardous situation which, if not avoided, could result in death or serious injury.**



#### **Caution**

**Indicates a hazardous situation which, if not avoided, could result in minor or moderate injury.**



#### **Notice**

**Is used to address practices not related to physical injury e.g. property damage.**



#### **Tip**

**Indicates information that may help the reader, but not hazard related.**

## 2.2 Safety Instructions

### 2.2.1 General Safety

- Read and understand the manual and all safety signs before you maintain the selection box.
- Install all protective covers and guards before you put the selection box into operation.
- Wear the correct protective clothing and equipment.
- Disconnect and isolate the electrical power supply before you clean or do maintenance on the selection box.
- Know the emergency medical center number for your area.
- Contact your local Lely service provider if you have any questions.

### 2.2.2 Electrical Safety

- Replace any damaged electrical lines, conduits, switches and components immediately.
- Isolate the electrical power supply at the master panel before you open the electrical panel to work on the electrical system.

### 2.2.3 Maintenance Safety

- Read and understand the applicable manual and all safety signs before you connect power supplies to maintain or adjust the selection box.
- Only trained persons are permitted to maintain the selection box.
- Disconnect and isolate the electrical power supply before you do work on the selection box.
- Do not climb on the selection box.
- Always use a proper stepladder when you do maintenance on the selection box.
- Always block the cow traffic to the return box before you do maintenance on the selection box.
- Make sure all covers and guards are installed when maintenance work is complete.

## 3 Specifications

### 3.1 Specifications and Requirements

| General Operational Conditions |                     |  |
|--------------------------------|---------------------|--|
| Ambient temperature            |                     | -15 to +40 °C (5 to 104 °F)  |
| Humidity                       |                     | 5 - 99% non condensing   |
| Power Supply                   |                     |  |
| Power supply                   |                     | 24 VDC   |
| Current                        |                     | 5 A  |
| Connected to                   |                     | Power box 24 VDC power supply  |
| Pressurized Air Supply         |                     |  |
| Pressure input                 |                     | 6 to 8 bar (87 to 112 PSI)   |
| Connected to                   |                     | Central unit or air compressor unit  |
| Network Connection             |                     |  |
| Cable type at least            |                     | LAN CAT.5e Ethernet cable, S-FTP 200 MHz (foil-screened twisted pair with overall screening (copper braiding)) with steel RJ-45 connector. |
| Maximum cable length           |                     | 100 meters (109 yd) (use a switch if the distance is more than 100 meter (109 yd))   |
| Radio Equipment                |                     |  |
| ISO Identification             | Frequency           | 134.2 kHz  |
|                                | Max. radiated power | 105.3 dBμA/m (at 1 m (3.3 ft))   |
| Control Box                    |                     |  |
| IP class                       |                     | IP55   |

5.1530.8532.0 C

## 3.2 Dimensions and Weight

### Grazeway Portal

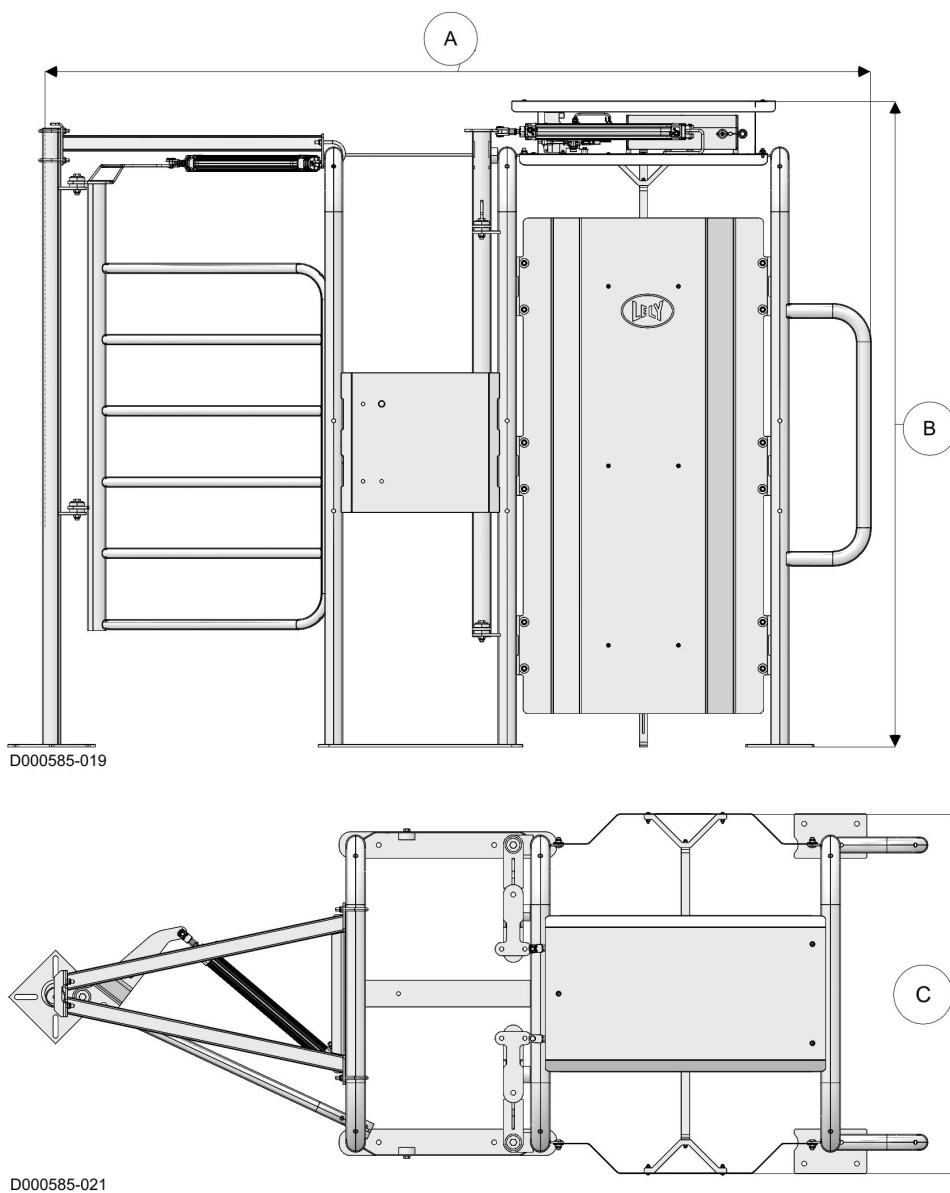

5.1530.8532.0 C

Figure 2. Grazeway portal side view and top view

**KEY:**

A: 271 cm (106 in)

B: 211 cm (83 in)

C: 109 cm (43 in)

Weight: approx. 266 kg (586 lb)



## Additional segregation gates

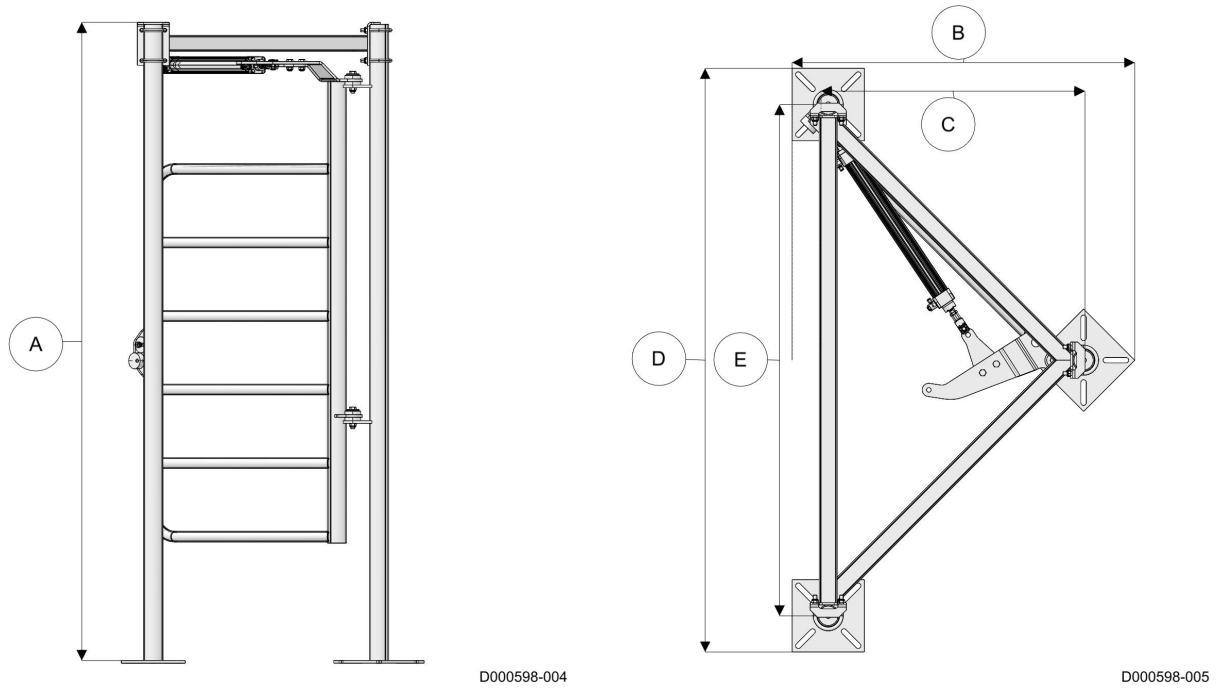

*Figure 3. Additional segregation gate side view and top view*

KEY:  
A: 200 cm (78 in)  
B: 95 cm (37 in)  
C: 74 cm (29 in)  
D: 161 cm (64 in)  
E: 141 cm (55.5 in)

Weight: approx. 68 kg (150 lb)



INTENTIONALLY BLANK

5.1530.8532.0 C

## 4 Description

### 4.1 General Description

The Grazeway selection box is a portal with a Texas gate and one or more direction gates. All cows must wear unique tags. In the Grazeway the cows tag is identified by the cow identification system. The Grazeway segregates cows in multiple directions based on the group the cow belongs to or state of the cow. This information is supplied to the Grazeway by the T4C farm management software.

The Grazeway is installed in the barn or outside the barn.

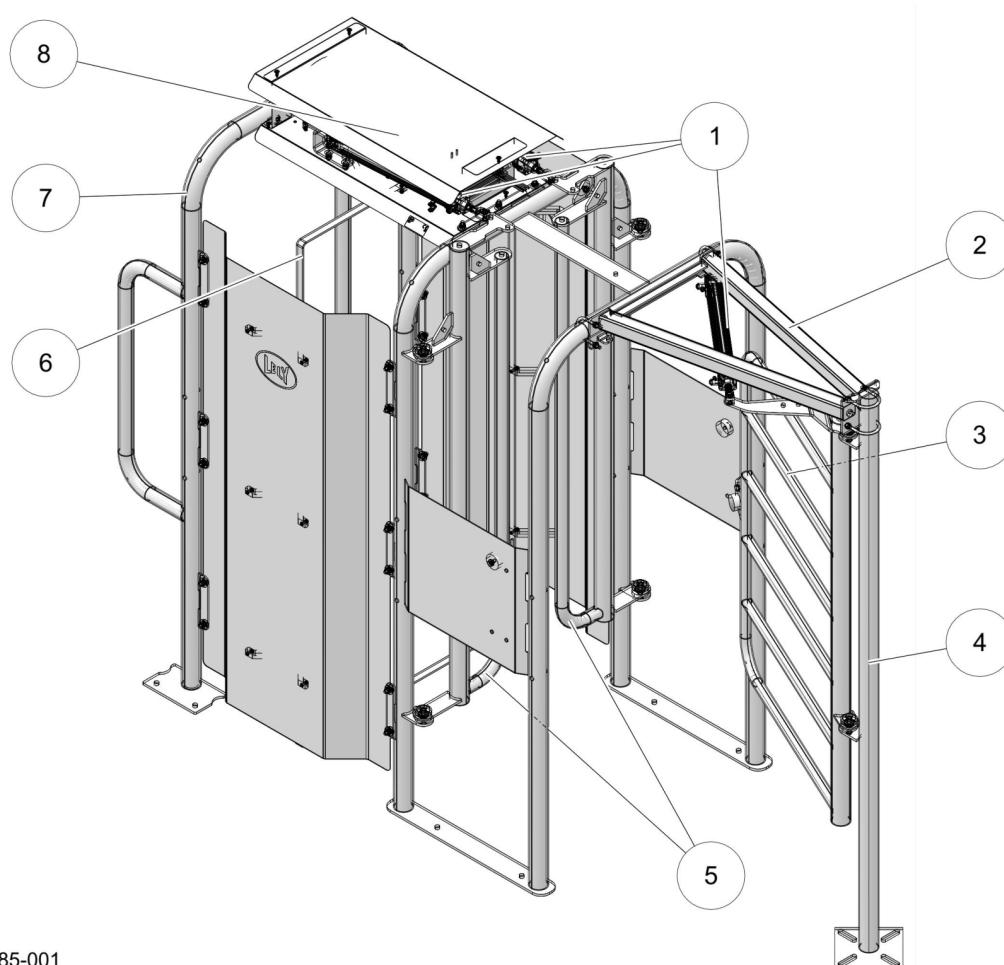

D000585-001

Figure 4. Main components

KEY: 1. Cylinders - 2. Top frame - 3. Segregation gate - 4. Pivoting post - 5. Texas gates - 6. Antenna (for ISO identification) - 7. Portal - 8. Control unit

The Grazeway has the following main parts:

- The portal and gates.
- The control unit.
- The cow identification reader.

- The additional segregation gate (optional).
- Software.

## 4.2 Portal, Frames and Gates

The portal (9) (see figure 4 on page 4-1) of the Grazeway has several frames and plates and two Texas gates (5). The top frame (2) is installed to the portal and a pivoting post (4). The segregation gate (3) is installed on the pivoting post. All frames and gates are galvanised.

The gates are operated by pneumatic cylinders (1). Each gate has a damper.

## 4.3 Control Unit

The control unit (10) (see figure 4 on page 4-1) is installed on top of the portal. On the bottom plate several parts (see figure 5 on page 4-2) are installed.

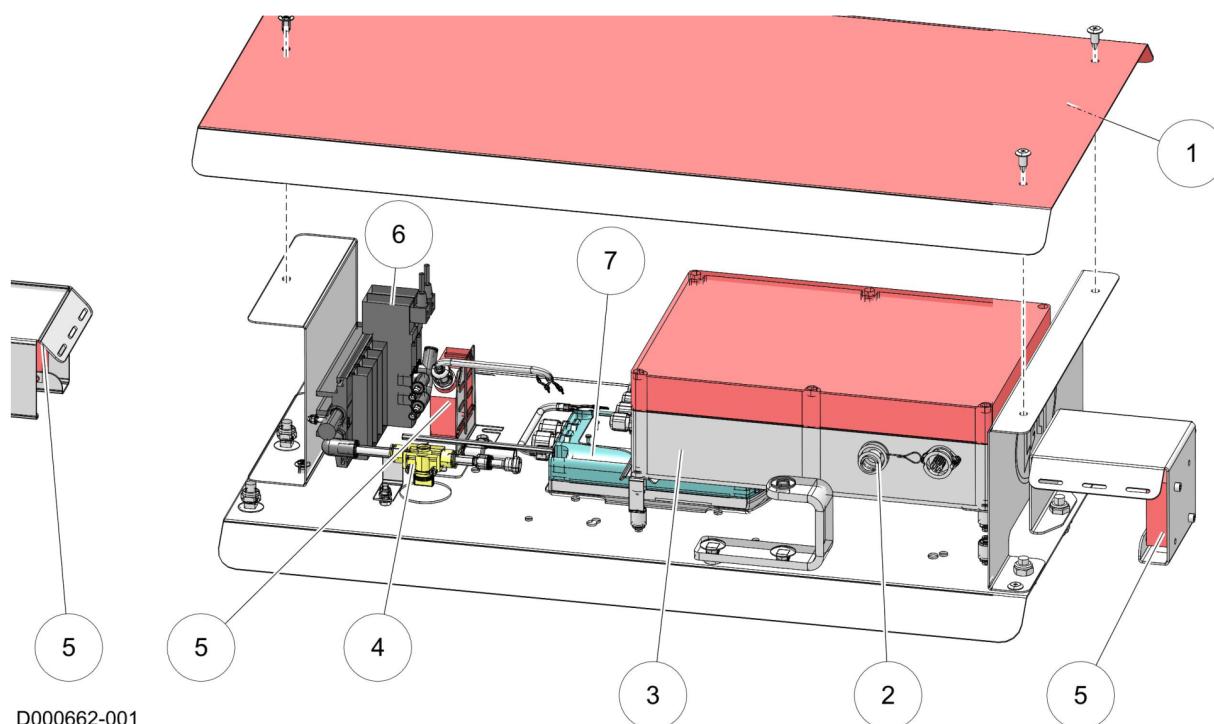

5.1530.8532.0 C

Figure 5. Control unit

KEY: 1. Cover - 2. E-Link connector - 3. Control box - 4. Main air supply valve - 5. Photocell - 6. Pneumatic valves block - 7. Qwes IR or LD reader (not on an ISO reader)

### 4.3.1 Control Box with PCB and Identification Control

The PCB on which the Grazeway software runs is installed in the control box (3) (see figure 5 on page 4-2). The PCB controls the solenoid valves that operate the gates. The pcb is connected to the photocell and registers if there is a cow inside the Grazeway.

The control box is connected to the box for identification control. When there is a cow in the Grazeway, the identification control identifies the cow. The pcb receives the ID of an identified cow. The pcb also receives information from T4C via the network cable and sends information to T4C.

### 4.3.2 Photocells

The photocell(s) have an emitting element (infrared LED) and receiving element (photodiode). If a cow is in the Grazeway it sends a signal to the PCB.

#### Grazeway with ISO ID

In a Grazeway with ISO ID there is one photocell:

- Photocell (5) (see figure 5 on page 4-2) is installed inside the control box, this photocell determines if there is a cow in the Grazeway.

#### Grazeway with IR or LD ID

In a Grazeway with IR and LD ID there are three photocells:

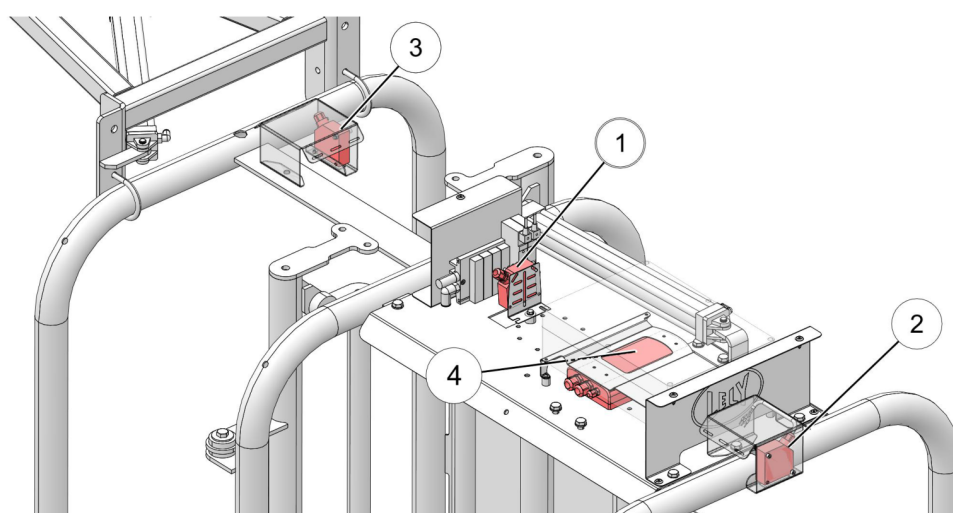

D000031-008

Figure 6. Location photocells Grazeway IR and LD reader

KEY: 1. Photocell 1 - 2. Photocell 2 switches on the IR or LD reader - 3. Photocell 3 detects that the cow has left the Grazeway - 4. Qwes IR or LD reader

- When photocell 2 (2) detects a cow in the Grazeway, the Qwes IR or LD reader is put in operation. The Qwes IR or LD reader reads the tag and sends the cow ID to the PCB. After that the Qwes IR or LD reader goes out of operation.
- If a second cow follows the first, photocell 2 will keep on detecting a cow. Only when photocell 3 (3) detects that the first cow has left the Grazeway, the reader is put in operation when photocell 2 detects a (second) cow.

### 4.3.3 Pneumatic Valves

The pneumatic valves block (6) (see figure 5 on page 4-2) has solenoid valves and operate the Cylinders on the gates. The pneumatic valves are controlled by the PCB.

A standard configuration has two solenoid valve and four blanking plates. If an additional segregation gate is installed, an additional solenoid valve is also installed.

#### 4.3.4 Main Valve Pressurized Air

The switch on the main valve to apply pressurized air (4) (see figure 5 on page 4-2) can be operated from inside the portal through a hole next to the photocell.

### 4.4 Cow Identification System

There are several types of tags for cows and ID readers. The tag is installed on a collar on the neck of the cow. The ID reader is installed in the Grazeway.

#### 4.4.1 ISO Identification Reader





The ISO identification reader has a Velos control box and an antenna PCB, which both are installed inside the control box (3) (see figure 5 on page 4-2) of the Grazeway.

The antenna is a ring through which the cow steps before she waits in front of the Texas gates.

#### 4.4.2 IR and LD Identification Reader

The Qwes IR reader and the Qwes LD reader are installed below the control box. They have a different control PCB and parts inside the reader box but they both operate the same way.

After a cow was detected by photocell 2, the reader is switched on and the infrared transmitter sends a signal. The antenna on the PCB in the reader box receives the data send by the tag on the cows neck. The status LEDs indicate the following:

| Status LED           |   | Function  |
|----------------------|---|---|
| Power LED            |  | On when power is on                               |
| Data read LED        |  | Is on for one second when data are read correctly |
| Photocell active LED |  | On when photocell is activated (not used)         |
| Data transfer LED    |  | Flashes during data transfer through CAN-bus      |

### 4.5 Additional Segregation Gate (Optional)

An additional segregation gate has several parts to install an extra segregation gate and a cylinder to operate the gate. Each additional segregation gate gives one extra direction for the cow. A maximum of 2 additional segregation gates can be installed and operated by the Grazeway.

### 4.6 Software

The Grazeway operates with the following software:

- Grazeway software that runs on the PCB, it has settings that can be adjusted via:

- E-Link (only available for Lely technicians)
- Web interface (only limited settings)
- T4C that runs on the T4C PC connected to the T4C network. Settings are adjustable on the PC.
- ID reader software, settings are adjustable on the ID reader control box using buttons and a display.

#### 4.6.1 Grazeway Software

The Grazeway software controls the opening of the gates.

With the use of an E-Link, a Lely technician has full access to the settings to configure the Grazeway in the Grazeway software.

#### 4.6.2 T4C management software

The Lely technician adds the Grazeway to the T4C management software during installation.

After that the routing criteria and directions can be set. See the online instruction guide “Your guide” in T4C, for more information about the following instructions:

- Add a location
- Add a routing area
- Set the assigned directions
- Set the near to be milked interval
- Add a scheduled routing task (manual routing)
- Adjust the manual routing
- Add an automatic routing task
- Adjust the automatic routing criteria

#### 4.6.3 ID Reader Software

The ID reader software identifies the cow and sends the ID information to the Grazeway control box.

- The ISO ID reader control box is located inside the Grazeway control box. It has a display and buttons that are used for configuration by the Lely technician during installation.
- The IR and LD reader are located below the Grazeway control box.

### 4.7 Operation

The Grazeway is connected to the T4C PC. In T4C the segregation criteria (for example segregation on attention, milk now, near to be milked) are set. T4C supplies the cow data to the Grazeway. When a cow enters the Grazeway, she is noted by the photocell and the identification system is activated. The ID reader reads the tag on the cow. The cow ID is confirmed and the cow is sent in the direction based on the segregation status of the cow. The cylinders are set to open the segregation gate(s) in the correct direction and to open the Texas gates.

If the tag cannot be read or the cow ID cannot be confirmed, the cow is sent in the default direction after 30 seconds. The default direction is specified in the Grazeway software settings and is adjustable in T4C.



INTENTIONALLY BLANK

5.1530.8532.0 C



## 5 Operating Instructions

### 5.1 General Instruction

---

**NOTICE**

There are no operating instructions for the Grazeway other than adjustments in T4C. For more information see the online instruction guide "Your guide".

---



INTENTIONALLY BLANK

5.1530.8532.0 C

## 6 Maintenance

### 6.1 Clean the Grazeway



*Unexpected cow movement.  
Risk of being crushed or trampled.  
Block the cow traffic.*



Do not spout water on the control box and photocell, this can cause damage to the electronics.

1. Use a high pressure cleaner to clean the portal and gates (2).
2. Use a wet brush or moist cloth to clean the top and bottom cover of the control unit.

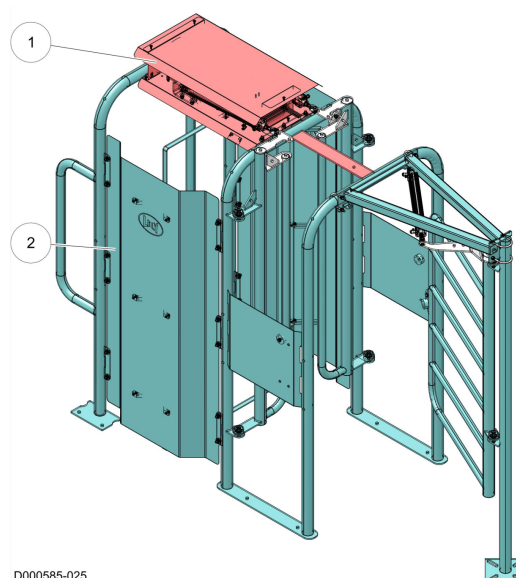

D000585-025

Figure 7. How to clean the parts of the Grazeway

KEY: 1. Do not spout water on the control unit, control box and photocells - 2. Cleaning with a high pressure cleaner is allowed on the frames and gates

## 6.2 Clean the Photocell



*Unexpected cow movement.  
Risk of being crushed or trampled.  
Block the cow traffic.*

1. Go inside the portal of the Grazeway.
2. Clean the photocells (1) with a soft moist towel and a small quantity of lens cleaner liquid. The Grazeway with ISO identification only has one photocell in the portal, other Grazeways have 3 photocells.

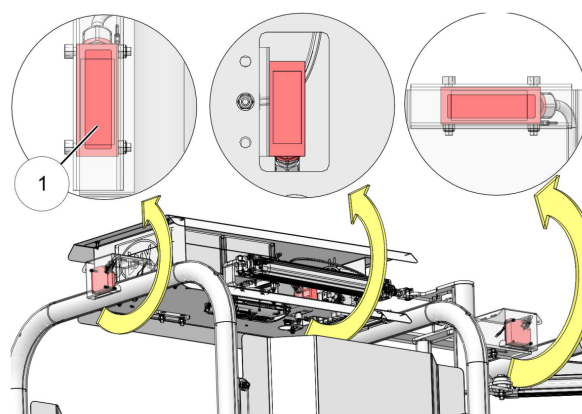

Figure 8. Photocell

KEY: 1. Photocell

5.1530.8532.0 C

## 6.3 Preventive Maintenance before the Winter Season



*Unexpected cow movement.  
Risk of being crushed or trampled.  
Block the cow traffic.*



When the Grazeway is not used during the winter season, it is best to close off the pressurized air supply and to keep up the power supply. The power supply gives the control box some warmth during the cold and wet season.

1. Close off the switch (2) on the air supply valve to the Grazeway.
2. Clean the cylinder shafts with a towel.
3. Lubricate all moving parts of the cylinders with haze oil (Purfiroc EP10 or similar).
4. Retract the cylinder shafts.

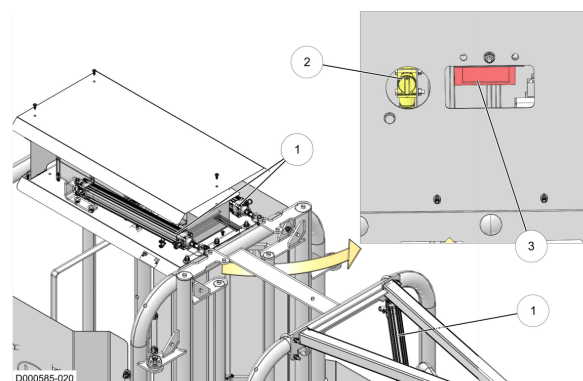

Figure 9. Control unit

KEY: 1. Cylinders - 2. Air supply switch - 3. Photocell - 4. Air valves block



INTENTIONALLY BLANK

5.1530.8532.0 C

## 7 Troubleshooting

| Symptom  | Possible Cause   | Solution   |
|--|--|--|
| The Texas gates open when there is no cow in the Grazeway. | The field of vision of the photocell is blocked.             | Clean the photocell.   |
|  | The beam of the photocell is reflected by a puddle of water. | Remove the puddle of water.  |
| A gate does not move (easily).                             | The gate is tied to the frame.                               | Untie the gate.  |
|  | There is no air pressure.                                    | Open the main pressurized air supply (2) (see figure 9 on page 6-3) to the Grazeway. |
|  | The settings are not correct.                                | Adjust the settings in T4C.  |
|  | If the problem persists.                                     | Call your local Lely service provider.   |
| Cows are sent in the wrong direction.                      | A destination is assigned to the wrong direction.            | Adjust the assigned direction for the conditions in T4C.                             |
|  | A routing task is not set correctly.                         | Adjust an automatic routing task or a scheduled task in T4C.                         |
|  | The default direction is not set correctly.                  | Adjust the default direction in T4C.   |
| Cow ISO tags are not identified                            | The ring antenna is not connected correctly.                 | Tighten the bolts of the ring antenna and make sure the ring is not interrupted.     |

5.1530.8532.0 C



INTENTIONALLY BLANK

5.1530.8532.0 C



## 8 Disposal

Disposing this product correctly will help save valuable resources and prevent any potential negative effects on human health and the environment, which could otherwise arise from inappropriate waste handling.

Decommissioning and disassembly of the product can be dangerous and must be done only by qualified recycling organizations. All components must be disposed in compliance with the local rules and regulations.

Lubricants and fluids must be disposed correctly to prevent pollution of the environment. Read the safety data sheets of the used lubricants and fluids for correct disposal. All lubricants and fluids must be disposed in compliance with the local rules and regulations.

Contact your local authority or local Lely service provider for further details.



INTENTIONALLY BLANK

5.1530.8532.0 C

## 9 WEEE

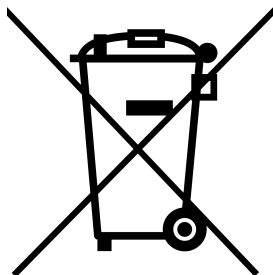

This symbol [crossed-out wheel bin WEEE Annex IV] indicates separate collection of electrical waste and electronic equipment in the European countries. We are committed to being a good corporate citizen. As part of that commitment, we strive to maintain an environmentally conscious manufacturing operation.

In accordance with the European Union WEEE (Waste Electrical and Electronic Equipment) Directive 2012/19/EC, we would like to notify you that this product might contain regulated materials, which upon disposal, according to the WEEE directive, require special reuse and recycling processing.

For this reason, Lely Industries N.V. has arranged that this product can be recycled at the local recycling/disposal companies to collect and recycle this product at no cost to you.

Additional local legislation may apply.

### NOTICE

Please note, only this product itself falls under the WEEE Directive. When disposing of packaging and other related shipping materials we encourage you to recycle these items through the normal channels.



INTENTIONALLY BLANK

5.1530.8532.0 C

# 10 EC Declaration of Conformity

EC DECLARATION OF CONFORMITY  
EG-KONFORMITÄTSEKHLÄRUNG  
DECLARATION DE CONFORMITÉ AUX NORMES DE LA CE  
DICHIARAZIONE CE DI CONFORMITÀ  
CERTIFICADO DE CONFORMIDAD CEE  
DECLARAÇÃO DE CONFORMIDADE CE  
DEKLARASJON EU MASKINDIREKTIV  
VAATIMUSTENMUKAISUUSVAKUUTUS  
EU-KONFORMITÄTSEKHLÄRUNG  
EG-FÖRSÄKRAN OM ÖVERENSSTÄMMELSE  
CB – SAMRÆMISYFIRLÝSING



innovators in agriculture  
ΔΗΛΩΣΗ ΣΥΜΜΟΡΦΩΣΗΣ Ε.Ε.  
DECLARAȚIE DE CONFORMITATE CE  
EU MEGFELELŐSÉGI NYILATKOZAT  
ES-PROHLÁŠENÍ O SHODĚ  
DEKLARACJA ZGODNOŚCI WE  
ES – PREHLÁSENIE O ZHODE  
VASTAVUS EU DIREKTIIVIDELE  
ES ATITIKTIES DEKLARACIJA  
ЗАЯВЛЕНИЕ О СООТВЕТСТВИИ НОРМАМ ЕС  
EG - POTVRDA O SUKLADNOSTI  
ES IZJAVA O SKLADNOSTI

## Wij fabrikant

We manufacturer  
Der Hersteller  
Nous, soussignés, le fabricant  
fabbricante  
fabricante  
producent  
valmistaja  
produsent  
tillverkare  
framleiðandi

Lely Industries N.V.  
Cornelis van der Lelylaan 1 • 3147 PB Maassluis • The Netherlands  
tel. +31 (0)88 - 12 28 221 • fax +31 (0)88 - 12 28 222  
www.lely.com

Εμείς, ο κατασκευαστής  
fabricant  
gyártó  
výrobce  
producent  
výrobca  
tootja  
gamintojas  
производитель  
proizvodač  
naziv proizvajalca

verklaren geheel onder eigen verantwoordelijkheid dat de machine:  
herewith declare, on our own responsibility, that the machinery:  
erklärt hiermit eigenverantwortlich, dass die Maschine:  
déclarons que les machines désignées ci-après :

## productbeschrijving

description of product  
Produktbezeichnung  
description du produit  
descrizione del prodotto  
nombre del producto  
designação de produto  
produktnavn  
tuotenimi  
produkt navn  
produkt namm  
vörulýsing

Lely Grazeway

περιγραφή του προϊόντος  
descrierea produsului  
termék megnevezése  
označení produktu  
opis produktu  
označenie výrobku  
toote kirjeldus  
gaminio aprašymas  
наименование изделия  
naziv proizvoda

## typenummer

model number  
Typnummer  
numéro de modèle  
numero di modello  
modelo  
número do modelo  
modelnummer  
mallinnumero  
modellnummer  
gerðarnúmer

5.1530.0050.x  
5.1530.0060.x  
5.1530.0070.x

αριθμός μοντέλου  
numărul modelului  
típus száma  
numer modelu  
typové číslo  
tüübi number  
modelio numeris  
номер модели  
broj modela  
števila artikla

waarop deze verklaring betrekking heeft, in overeenstemming is met de bepalingen van de volgende Richtlijn(en):  
which this declaration refers to, is in accordance with the conditions of the following Directive(s):  
worauf sich diese Erklärung bezieht, hergestellt ist gemäß den Bestimmungen der Richtlinie(n):  
auxquelles la présente déclaration se rapporte, sont conformes aux dispositions de la ou des directives suivantes :

è conforme alle direttive  
de acuerdo con las directivas  
de acordo com a directiva  
opfylder følgende direktiver  
täyttää seuraavien direktiivien vaatimukset  
opfylder følgende direktiver  
uppfyller följande direktiv  
uppfyllir eftirfarandi tilskipanir

Machinery directive 2006/42/EC

conform cu directivele  
rendelkezeseknek megfelelően  
podle směrnice  
zgodny z dyrektywą  
v zhode so smernicami  
direktiivide järgi  
pagal direktyvas  
соответствует требованиям директив  
po smjernicama  
v skladu z direktivo

en in overeenstemming is met de volgende normen of andere normatieve documenten :  
and is in conformity with the following standard(s) or other such specifications :  
und den folgenden Normen oder vergleichbaren Spezifikationen entspricht:  
et aux normes et autres spécifications suivantes :

è conforme alle norme  
de acuerdo con las normas  
de acordo com as normas  
opfylder følgende standarder  
täyttää seuraavien standardien vaatimukset  
opfylder følgende standard  
uppfyller följande standarder  
uppfyllir eftirfarandi staðla  
πληροί τις προδιαγραφές

EN-ISO 12100:2010  
EN 60950-1:2006/A2:2013

în conformitate cu standardele  
megfelel a szabványoknak  
odpovídá normám  
zgodny z normą  
zodpovedá normám  
normidele vastavus  
atitinka standartus  
соответствует стандартам нормам  
u skladu sa standardima  
v skladu s standardi

## handtekening en datum

signature and date  
Unterschrift und Datum  
signature et date  
firma e data  
firma y fecha  
assinatura e data  
underskrift og dato  
allekirjotus ja päiväys  
signatur og dato  
underskrift och datum  
undirskrift og dagsetning

S. Loosveld  
Director Product Development  
Lely Industries N.V.

J.W. Rodenburg  
Manager Product Safety & Compliance  
Lely Industries N.V.

17-6-2019



INTENTIONALLY BLANK

5.1530.8532.0 C



**Lely Industries N.V.**

Cornelis van der Lelylaan 1

NL-3147 PB Maassluis

Tel +31 (0)88 - 12 28 221

Fax +31 (0)88 - 12 28 222

